

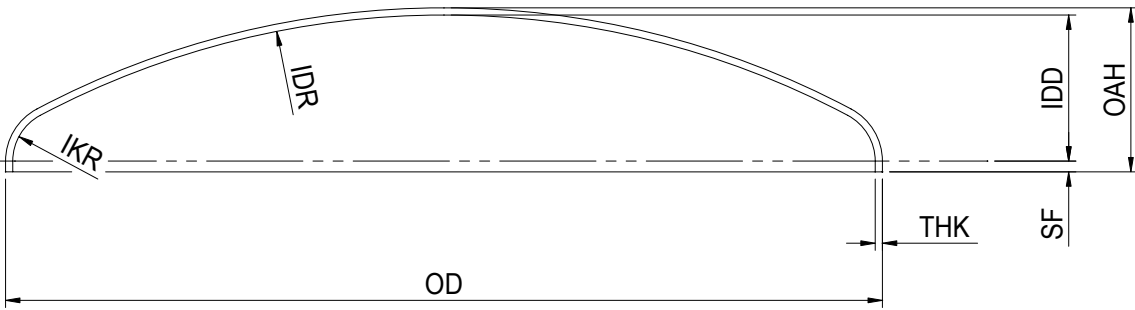

**BRIGHTON  
TRU-EDGE HEADS**

# ASME FLANGED AND DISHED



IKR - Inside Knuckle Radius  
 IDR - Inside Dish Radius  
 THK - Thickness  
 OD - Outside Diameter  
 SF - Straight Flange  
 IDD - Inside Depth of Dish  
 OAH - Overall Height

## SPECIFICATIONS

Inside Dish Radius - Typically 100% of Diameter (*See ASME Section VIII Division 1, UG-32 for clarification*)  
 Inside Knuckle Radius - At least 6% of Diameter (*See ASME Section VIII, Division 1, UG-32 for clarification*)  
 Typical Thin Out Allowance - 1/2" and Under - Add .03125" to the minimum  
 - Over 1/2" - Add .0625" to the minimum

Diameter	10 GA	3/16	1/4	5/16	3/8	1/2	5/8	3/4	1	1 1/4	1 1/2
12	X	X	X								
18	X	X	X	X	X	X					
24	X	X	X	X	X	X					
30	X	X	X	X	X	X					
48	X	X	X	X	X	X	X	X	X		
60	X	X	X	X	X	X	X	X	X		
72	X	X	X	X	X	X	X	X	X		
84		X	X	X	X	X	X	X	X	X	X
96		X	X	X	X	X	X	X	X	X	X
108		X	X	X	X	X	X	X	X	X	X
120		X	X	X	X	X	X	X	X	X	X
132		X	X	X	X	X	X	X	X	X	X
144		X	X	X	X	X	X	X	X	X	X
156			X	X	X	X	X	X	X	X	X
168			X	X	X	X	X	X	X	X	X
174			X	X	X	X	X	X	X	X	X
192			X	X	X	X	X	X	X	X	X
216				X	X	X	X	X	X	X	X
240				X	X	X	X	X	X	X	X
*288				X	X	X	X	X	X	X	

\*Heads over 288" can be fabricated as segmented heads. Heads over 1-1/2" on application.

Parameters are given as reference only. Please call your salesman for specific inquiries.

Other sizes and thickness, including light gauge jacket heads, are available on application.

Ask us about polishing, burning nozzle openings, or applying jacketing to your ASME Flanged and Dished Heads.