

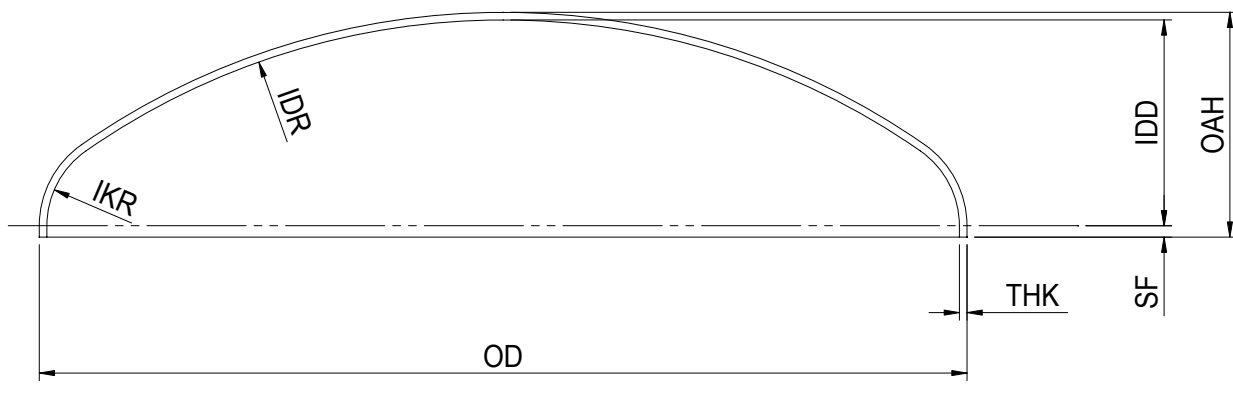

**BRIGHTON  
TRU-EDGE HEADS**

# ASME HIGH CROWN



IKR - Inside Knuckle Radius  
 IDR - Inside Dish Radius  
 THK - Thickness  
 OD - Outside Diameter  
 SF - Straight Flange  
 IDD - Inside Depth of Dish  
 OAH - Overall Height

## SPECIFICATIONS

Inside Dish Radius - 80% of Diameter  
 Inside Knuckle Radius - 6% of Diameter  
 Typical Thin Out Allowance - 1/2" and Under - Add .0625" to the minimum  
 - Over 1/2" - Add .0625" or 15% of minimum, whichever is greater

Diameter	3/16	1/4	5/16	3/8	1/2	3/4	1	1 1/4	1 1/2
24	X	X	X	X	X				
36	X	X	X	X	X				
42	X	X	X	X	X				
48	X	X	X	X	X	X	X		
60	X	X	X	X	X	X	X		
72	X	X	X	X	X	X	X	X	X
84	X	X	X	X	X	X	X	X	X
96	X	X	X	X	X	X	X	X	X
108		X	X	X	X	X	X	X	X
120		X	X	X	X	X	X	X	X
132		X	X	X	X	X	X	X	X
144		X	X	X	X	X	X	X	X
156			X	X	X	X	X	X	X
168			X	X	X	X	X	X	X
180			X	X	X	X	X	X	X
192			X	X	X	X	X	X	X
204				X	X	X	X	X	
216				X	X	X	X	X	
228				X	X	X	X	X	
240				X	X	X	X	X	
252				X	X	X	X	X	
264				X	X	X	X	X	
276				X	X	X	X	X	

\*Heads over 276" can be fabricated as segmented heads. Head over 1-1/2" on application.

Parameters are given as reference only. Please call your salesman for specific inquiries.

Other sizes and thickness, including light gauge jacket heads, are available on application.

Ask us about polishing, burning nozzle openings, or applying jacketing to your ASME High Crown Heads.